

FBJ®

7200 Series

Angular Contact Ball Bearings

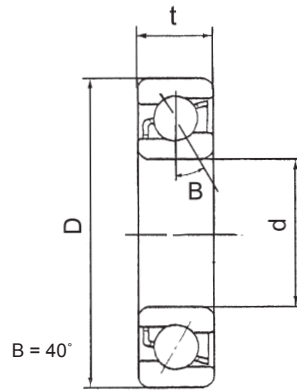

Ball / Roller Bearing

Bearing Number	Dimensions (mm)			Basic Load Ratings (N)		Limiting Speeds (rev/min)		Weight kg
	Bore d	OD D	Width t	C_r	C_{or}	Grease	Oil	
7200 B	10	30	9	7020	3350	19000	28000	0.030
7201 B	12	32	10	7610	3800	18000	26000	0.036
7202 B	15	35	11	8840	4800	17000	24000	0.045
7203 B	17	40	12	11100	6100	15000	20000	0.065
7204 B	20	47	14	14000	8300	12000	17000	0.110
7205 B	25	52	15	15600	10200	10000	15000	0.130
7206 B	30	62	16	23800	15600	8500	12000	0.200
7207 B	35	72	17	30700	20800	8000	11000	0.280
7208 B	40	80	18	36400	26000	7000	9500	0.370
7209 B	45	85	19	37700	28000	6700	9000	0.420
7210 B	50	90	20	39000	30500	6000	8000	0.470
7211 B	55	100	21	48800	38000	5600	7500	0.620
7212 B	60	110	22	57200	45500	5000	6700	0.800
7213 B	65	120	23	66300	54000	4500	6000	1.000
7214 B	70	125	24	71500	60000	4300	5600	1.100
7215 B	75	130	25	72800	64000	4300	5600	1.200
7216 B	80	140	26	83200	73500	3800	5000	1.450
7217 B	85	150	28	95600	83000	36000	4800	1.850
7218 B	90	160	30	10800	96500	3400	4500	2.300
7219 B	95	170	32	124000	108000	3200	4300	2.700
7220 B	100	180	34	135000	122000	3000	4000	3.300
7221 B	105	190	36	148000	137000	2800	3800	3.950
7222 B	120	200	38	163000	153000	2600	3600	4.600
7224 B	100	215	40	165000	163000	2200	3200	6.100

*For Brass cage add, Suffix 'M'.

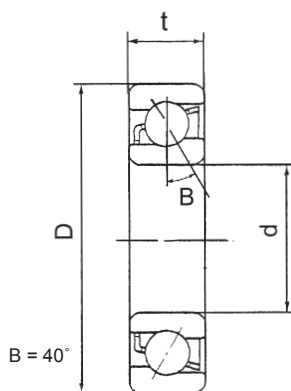

Bearing Number	Dimensions (mm)			Basic Load Ratings (N)		Limiting Speeds (rev/min)		Weight kg
	Bore d	OD D	Width t	C_r	C_{or}	Grease	Oil	
7302 B	15	42	13	13000	6700	15000	20000	0.08
7303 B	17	47	14	15900	8300	13000	18000	0.11
7304 B	20	52	15	19000	10400	11000	16000	0.14
7305 B	25	62	17	26000	15600	9000	13000	0.23
7306 B	30	72	19	34500	21200	8000	11000	0.34
7307 B	35	80	21	39000	24500	7500	10000	0.45
7308 B	40	90	23	49400	33500	6700	9000	0.63
7309 B	45	100	25	60500	41500	6000	8000	0.85
7310 B	50	110	27	74100	51000	5300	7000	1.10
7311 B	55	120	29	85200	60000	4800	6300	1.40
7312 B	60	130	31	95600	69500	4500	6000	1.75
7313 B	65	140	33	108000	80000	4300	5600	2.15
7314 B	70	150	35	119000	90000	3800	5000	2.65
7315 B	75	160	37	133000	106000	3600	4800	3.20
7316 B	80	170	39	143000	118000	3400	4500	3.80
7317 B	85	180	41	153000	132000	3200	4300	4.45
7318 B	90	190	43	165000	146000	3000	4000	5.20
7319 B	95	200	45	178000	163000	2800	3800	6.05
7320 B	100	215	47	203000	190000	2600	3600	7.50

* For Brass cage, add Suffix 'M'.

**Double Row
5200 Series**

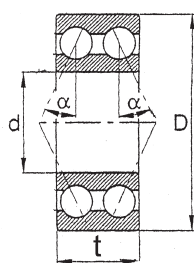

$\alpha = 25^\circ$ OPEN

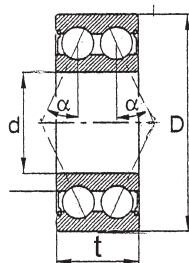

-2Z

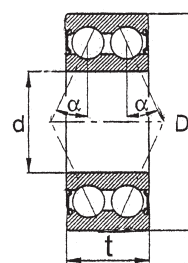

-2RS

**Angular Contact
Ball Bearings**

Ball / Roller Bearing

Bearing Number	Dimensions (mm)			Basic Load Ratings (kN)		Limiting Speeds (rev/min)		Weight kg
	Bore d	OD D	Width t	C_r	C_{or}	Grease	Oil	
5200	10	30	14.3	6.95	3.80	14000	19000	0.094
5201	12	32	15.9	9.15	5.05	13000	17000	0.057
5202	15	35	15.9	10	6.05	11000	15000	0.064
5203	17	40	17.5	13.2	8.15	11000	14000	0.091
5204	20	47	20.6	19.7	12.60	8800	12000	0.120
5205	25	52	20.6	21.4	14.80	7700	10000	0.190
5206	30	62	23.8	29.7	21.30	6400	8600	0.290
5207	35	72	27	39.2	29.00	5500	7300	0.430
5208	40	80	30.2	44.4	33.60	5000	6700	0.570
5209	45	85	30.2	49.9	38.40	4600	6100	0.620
5210	50	90	30.2	53.3	43.60	4300	5600	0.670
5211	55	100	33.3	65.9	55.20	3800	5100	0.960
5212	60	110	36.5	74.4	60.80	3500	4700	1.360
5213	65	120	38.1	86.9	75.30	3200	4300	1.660
5214	70	125	39.7	94.5	82.60	3100	4100	1.810
5215	75	130	41.3	92.4	120.00	2900	3900	2.100

5300 Series

Angular Contact Ball Bearings

Bearing Number	Dimensions (mm)			Basic Load Ratings (kN)		Limiting Speeds (rev/min)		Weight kg
	Bore d	OD D	Width t	C_r	C_{or}	Grease	Oil	
5302	15	42	19	17.2	10.1	9900	13000	0.132
5303	17	47	22.2	20.4	12.1	9000	12000	0.181
5304	20	52	22.2	20.6	12.7	8000	11000	0.217
5305	25	62	25.4	30.5	20.5	6700	8900	0.362
5306	30	72	30.2	39.5	27.5	5700	7600	0.553
5307	35	80	34.9	49.5	35	5000	6600	0.766
5308	40	90	36.5	60.5	44	4400	5900	1.01
5309	45	100	39.7	72.5	54	4000	5300	1.34
5310	50	110	44.4	85.5	64.5	3600	4800	1.81
5311	55	120	49.2	106	82	3300	4400	2.32
5312	60	130	54	122	95.5	3000	4000	3.05
5313	65	140	58.7	138	109	2800	3700	3.96
5314	70	150	63.5	155	125	2600	3500	4.74
5315	75	160	68.3	168	141	2400	3200	5.65